

Ball Valve

with Hand - Gear

DN 6" - 24"

ASME Class 150 - 900



INNO-BALL

Design

Split-body ball valve.

Trunnion mounted ball.

With soft seats or metal seats.

With full bore.

Actuator attachment acc. to DIN ISO 5211.

Dimensions (in mm)

Size (DN)	6"	8"	10"	12"	14"	16"	18"	20"	24"
(Class 150) - L	394	457	533	610	686	762	864	914	1067
(Class 300) - L	403	502	568	648	762	838	914	990	1143
(Class 600) - L	559	660	787	883	889	991	1092	1194	1397
(Class 900) - L	610	737	838	965	1029	1130	1219	1321	1549
H1 (max)	500	720	770	830	890	980	1130	1250	1360
H2 (max)	190	200	280	340	390	420	450	490	550
D (max)	500	700	700	700	700	700	1000	1000	1000
(Class 150) - Weight (kg)	170	330	505	650	915	1167	1130	1280	1900
(Class 300) - Weight (kg)	190	360	535	690	1027	1314	1181	1582	2157
(Class 600) - Weight (kg)	200	450	725	910	1050	1270	1860	2420	3420
(Class 900) - Weight (kg)	360	570	835	1010	1290	1630	2310	2820	4210

up to DN 28" and up to ANSI Class 1500 on request.

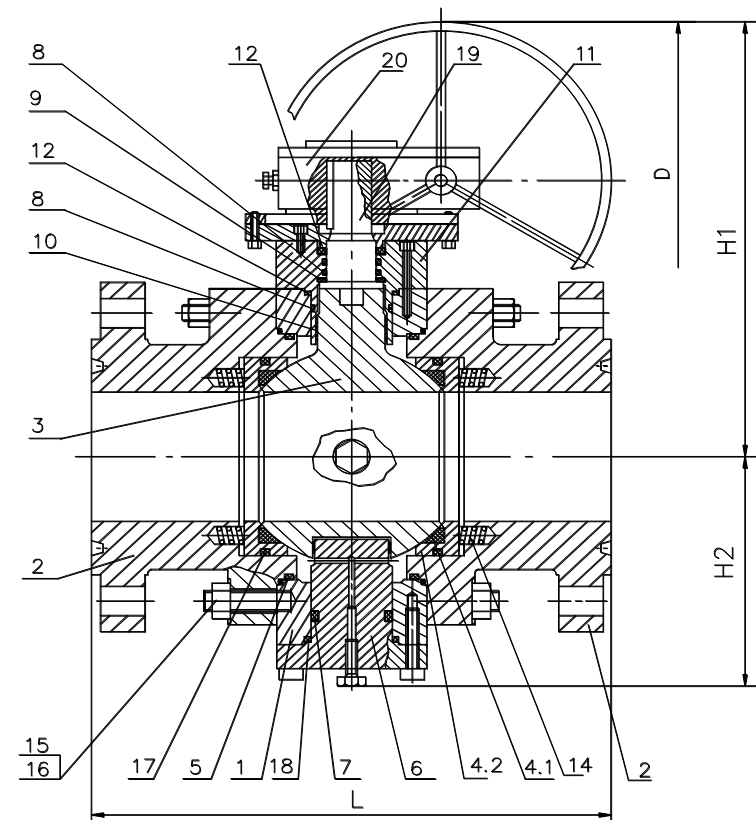

INNO-BALL

Material (DIN-Material on request)

Item	Part name	Carbon steel to ASTM Type A105 / WCB	Alloy steel to ASTM Type LF2 / LCB	Stainless steel to ASTM Type F316 / CF8M
1	Body	A105 / A216 WCB	A350 LF2 / A 352 LCB	A182 F316 / A351 CF8M
2	Body part	A105 / A216 WCB	A350 LF2 / A 352 LCB	A182 F316 / A351 CF8M
3	Ball	A351 CF8M / A105+ENP	A182 F316 / A351 CF8M	A182 F316 / A351 CF8M
4.1	Ball seat ring compl.	PTFE - Glass	PTFE - Glass	PTFE - Glass
4.2		A182 F316 Ti	A182 F316 Ti	A182 F316 Ti
5	Body gasket	Graphite / PTFE	Graphite / PTFE	Graphite / PTFE
6	Trunion	ENP A105+ENP	A350 LF2	A351 CF8M
7	Lower stem seal	Graphite / PTFE - Glass / Viton	Graphite / PTFE - Glass / Viton	Graphite / PTFE - Glass Viton
8	Upper stem seal	Graphite / PTFE	Graphite / PTFE	Graphite / PTFE
9	Bearing	PEEK	PEEK	PEEK
10	Lower and upper bearings	PTFE / A182 F316	PTFE / A182 F316	PTFE / A182 F316
11	Cover	A216 WCB / A105	A350 LF2	A182 F316 Ti
12	Cover gasket	Graphite / PTFE	Graphite / PTFE	Graphite / PTFE
13	Ring	A182 F316 Ti	A182 F51	A351 CF8M
14	Spring	17 - 7PH	Inconel	17 - 7PH / Inconel
15	Hex. bolt	A194 B7	A320L7M	A193 B8
16	Nuts	A194 2H	A194 7M	A194 8
17	Seat ring gasket	Graphite / PTFE	Graphite / PTFE	Graphite / PTFE
18	Gasket	Graphite / PTFE	Graphite / PTFE	Graphite / PTFE
19	Stem	A 182-F316	A 182-F316	A 182-F316
20	Gear operator	Steel	Steel	Steel

Special materials on request.

Specification

Marking	EN19, CE
Face-to-face dimensions	ASME B16.10
Flanged ends, dimensions as per	ASME B16.5
Pressure-Temperature Rating	ASME B16.34
Valve Inspection & Testing	API 598
	AD-2000, EN 12266-2 (DIN 3230 part 3) on request

All of our valves are subject to a steady technological progress and improvement. So details might change without prior notification.